

**Planning and Development Acts 2000 to 2018**  
**Planning and Development Regulations 2001 to 2018**

**REPORT ON TAKING IN CHARGE:**

<b>Planning Reference:</b>	<b>TC59</b>
<b>Development:</b>	<b>The Greens, Jerpoint West, Thomastown, Co. Kilkenny (Realigned Section of L-8203)</b>
<b>Developer:</b>	<b>Pierce Construction</b>
<b>Planning Permission Reference:</b>	<b>P03/960 and P09/193</b>

---

**Site Location & Description**

The Greens is a residential development consisting of 51 dwellings located on the outskirts of Thomastown Town. The dwellings are a mixture of detached, semi-detached and terraced 2 storey units. Access to dwellings is via a single access onto a realigned section of roadway (L-8203).

**Planning History**

P03/960: Permission granted subject to 29 no. conditions to EMO Estates Ltd. on 31<sup>st</sup> August 2004.

P09/193: Extension of duration of P03/960 granted on 17<sup>th</sup> June 2009.

The current 51 houses were completed as phase I of P03/960.

**TIC Request:**

The formal application to have this development taken in charge was made by the developer on 19<sup>th</sup> December 2013. The application was referred to the various internal service areas to ascertain the extent of any outstanding works. The developer has engaged with the council and prepared CCTV surveys and as-built drawings and has to date completed most of the outstanding items.

Towards the end of 2018, the developer completed the realignment of the public road to the front of the development. The work involved the construction of a new section of roadway leaving sections of the original road in place as 2 no. cul-de-sacs as access for

local traffic. Whilst some items of work remain to be completed it is intended to commence the taking in charge of this section of road at this point in time to allow for the smooth handover of the road to the council upon final completion in the coming months. Works are ongoing within the development itself and it is hoped that the remainder of the development will also be taken in charge in 2019.

**Recommendation:**

Having regard to the substantial completion of the realigned section of public road to the front of the development and having regard to the expected completion of such works, I recommend that Kilkenny County Council initiate proceedings for the formal taking in charge of this section of roadway, as outlined on the attached map.

SIGNED: Brendan Sheahan  
Brendan Sheahan  
Executive Engineer

Date: 08/2/18

A. Fitzpatrick  
Annette Fitzpatrick  
Administrative Officer

Date: 08/2/18

Jerpoint West Td.

Newtown (E.D. Thomastown) Td.

BASED ON ORDNANCE SURVEY OF IRELAND MAP LICENCE NO. KILKENNY CCMA 08/12

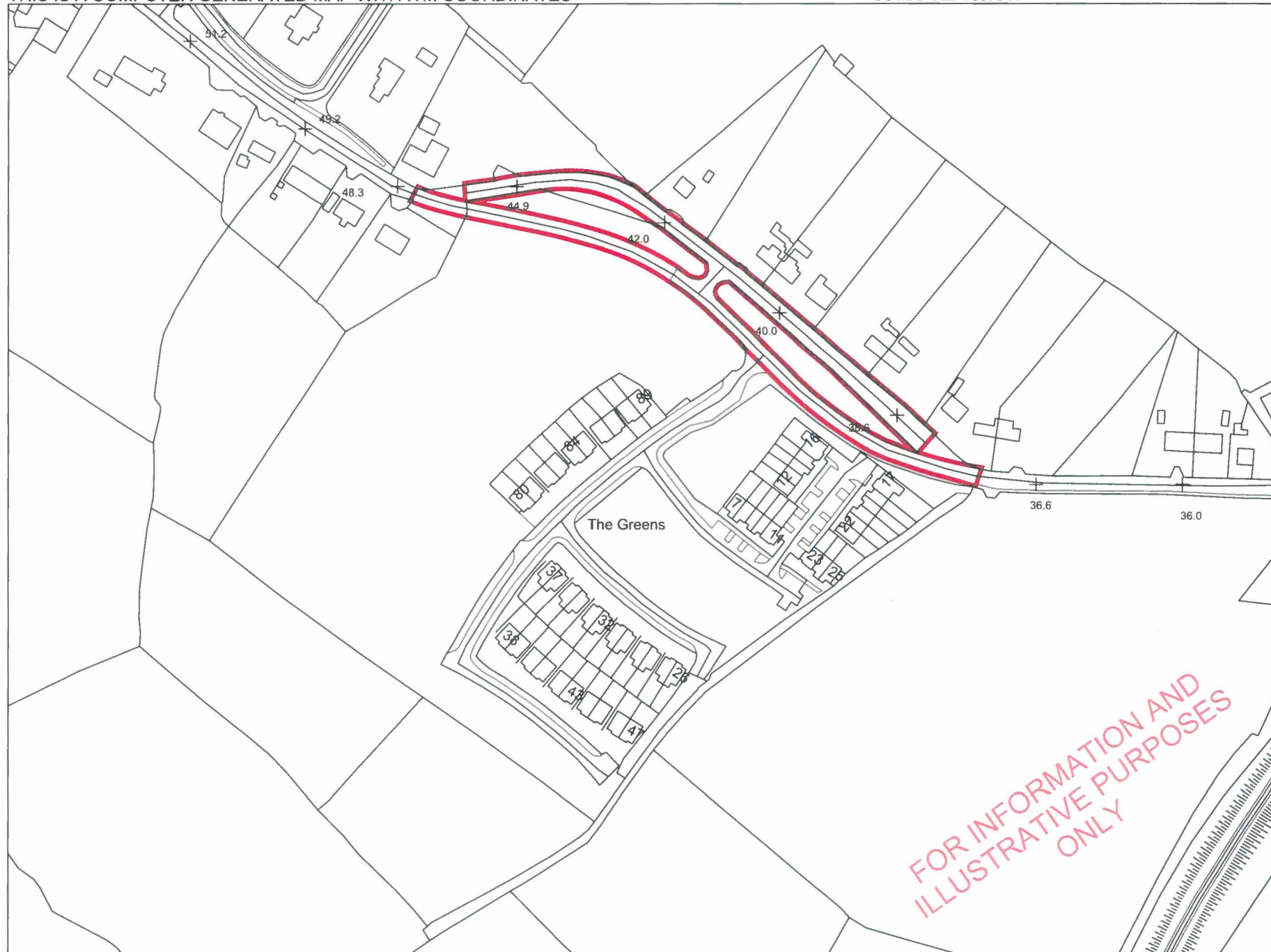

E657093 N641280

# Declaration of Public Roads at Newtown (E.D. Thomastown) and Jerpoint West

## Road Lengths:

Realigned Section of L-8203: 305m approx.  
Old Sections of L-8203 (now cul-de-sacs): 260m approx.  
Link between Realigned Section and old road: 18m approx.

Scale: 1:2500 @ A4

Plot Date: 11/01/2019

Drm: BLS

Comhairle Chontae Chill Chainnigh  
Kilkenny County Council

County Hall, John Street, Kilkenny  
Tel: 056 7794000  
Fax: 056 7794004  
Web: [www.kilkennycoco.ie](http://www.kilkennycoco.ie)



