



Ref: IC 142

12th October 2020

TO: An Cathaoirleach
& Each Member of Kilkenny County Council

RE: Taking in Charge of Estates
Section 11 of the Roads Act, 1993
Section 180 of the Planning & Development Act, 2000
As amended by Section 59 of the Planning & Development Act 2010

ESTATE: Cois na Bearu, Graiguenamanagh, Co. Kilkenny.

In accordance with the decision of the Council on 17th September, 2018 a notice was published stating that Kilkenny County Council proposed to declare the road in the schedule hereunder to be a public road in accordance with the provisions of Section 11 of the Roads Act, 1993 in order to facilitate the taking in charge of the estate in accordance with Section 180 of the Planning & Development Act, 2000 as amended by Section 59 of the Planning & Development Act, 2010.

Written representations or objections in relation to the taking in charge were invited from the public. No objections or representations were received and the estate was completed in a satisfactory manner. In addition, the road is considered to be of a public utility. There are little or no financial implications in taking this estate in charge.

I therefore recommend that Kilkenny County Council resolve to take the estate in charge and that the roads be declared public roads and entered into the roads schedule of Kilkenny County Council.

SIGNED:

Sean McKeown
Director of Services
Planning

Bohermore Td

Tinnapark Td

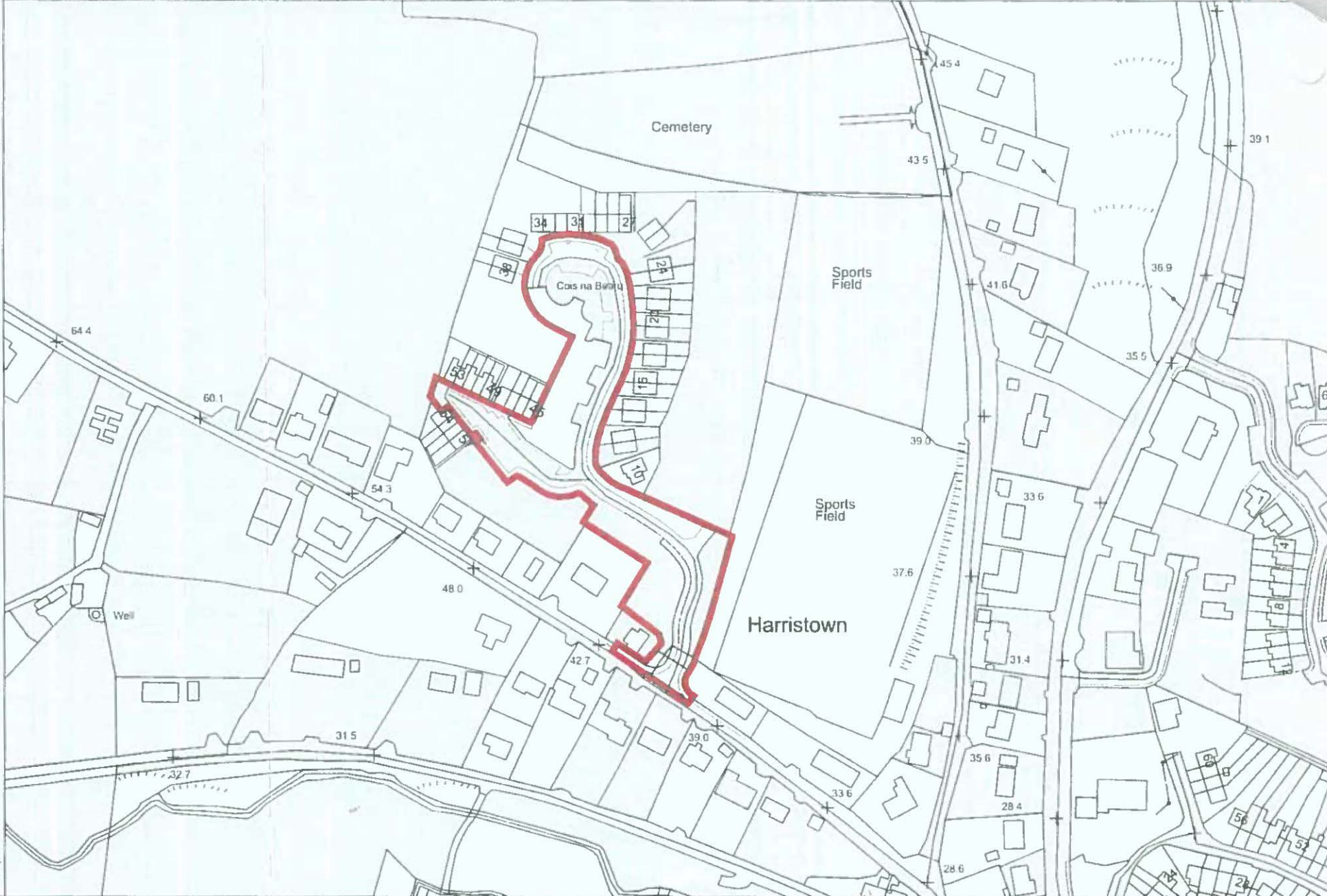

E670063 N644188

Lands at Bohermore, Graiguenamanagh, Co. Kilkenny

AREA OF SITE OUTLINED IN RED = 0.89 Ha
 FOLIO - KK15387 (part of), KK24984 (part of), KK29194F (part of)

FOR INFORMATION
 PURPOSES ONLY

Scale	1:2500 @ A4
Plot Date	09/07/2018
Drn	BLS

Graiguenamanagh Td.

Comhairle Chontae Chill Chainnigh
 Kilkenny County Council
 County Hall, John Street, Kilkenny
 Tel: 056 7791000
 Fax: 056 7794004
 Web: www.kilkennyccoco.ie

