



Comhairle Chontae Chill Chainnigh

Halla an Chontae Sraid Eoin Cill Chainnigh
R95 A39T

Pobail agus Áiteanna Inbhuanaithe a Chruthú

Kilkenny County Council

County Hall John Street Kilkenny
R95 A39T

Creating Sustainable Communities and Places



Date: 7th November, 2022

Our ref: D28/434/B

**TO: THE CATHAOIRLEACH
AND EACH MEMBER OF KILKENNY COUNTY COUNCIL**
RE: DISPOSAL OF INTEREST IN PLOT OF LAND AT KILCREENE, KILKENNY

A Chara,

Notice is hereby given, that at a meeting of the Council to be held after the expiration of 10 days from the date of this notice, it is the intention of Kilkenny County Council, in accordance with Section 183 of the Local Government Act, 2001, to dispose of its interest in plot of land at Kilcreene, Kilkenny (as identified on the attached map) to Brian Dowling & Agnes Dowling, Clonsharra, Kilcreene, Kilkenny for the nominal fee of €1,500 (fifteen hundred euro) and each party will be responsible for their own legal costs associated with the sale. Kilkenny County Council will erect a post & rail fence along the new boundary line. Area measures 0.286 acre. The Consent of the Minister for Housing, Local Government and Heritage is not required.

BACKGROUND

Mr. & Mrs. Dowling contacted Kilkenny County Council in December, 2015 seeking to acquire a plot of ground measuring 0.286 acre. This plot of ground is adjacent to the Dowlings' garden and has been maintained by them for the past 28 years. It has now been agreed to dispose of the plot of ground to the Dowlings' to rectify their title.

Mise, le meas,

Martin Prendiville

Martin Prendiville
Director of Services
Property Management

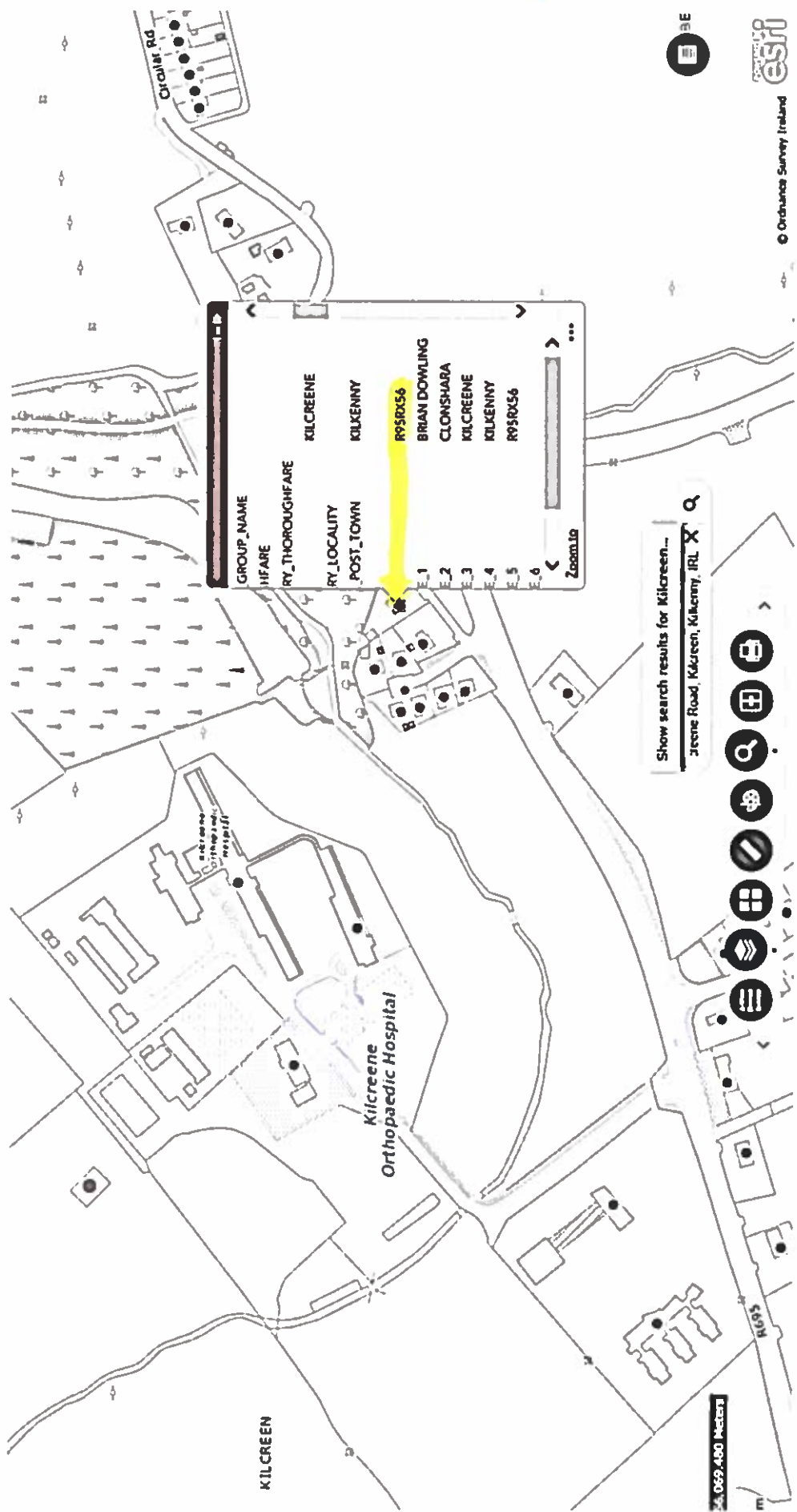

GROUP_NAME	RY_THOROUGHFARE	RY_LOCALITY	POST_TOWN
			KILCREENE
			KILKENNY
			R95RX56
			BRIAN DOWLING
			CLONSHARA
			KILCREENE
			KILKENNY
			R95RX56

Show search results for Kilkreeen...
Circular Road, Kilkreeen, Kilkenny, IRL



esri

Ordnance Survey Ireland

0,069,400 meters

Land Registry Compliant Map



National Mapping Agency

CENTRE COORDINATES:
ITM 848283.655854

PUBLISHED: ORDER NO.:
29/03/2022 50259000

MAP SERIES: MAP SHEETS:
1:2,500 4766-A

COMPILED AND PUBLISHED BY
Ordnance Survey Ireland,
Phoenix Park,
Dublin 8,
Ireland

Unauthorized reproduction
infringes Ordnance Survey Ireland
and Government of Ireland
copyright.

All rights reserved.
No part of this publication may
be copied, reproduced
or transmitted in any form
or by any means without the prior
written permission of
the copyright owners

The representation on this map
of a road, track or footpath
is not evidence of the existence
of a right of way.

Ordnance Survey maps
never show legal property
boundaries, nor do they
show ownership of
physical features.

© Suirbhéireacht Ordnáis Éireann
2022
© Ordnance Survey Ireland, 2022
www.osi.ie/copyright

LEGEND:
<http://www.osi.ie>,
search 'Land Scale 1:2500'

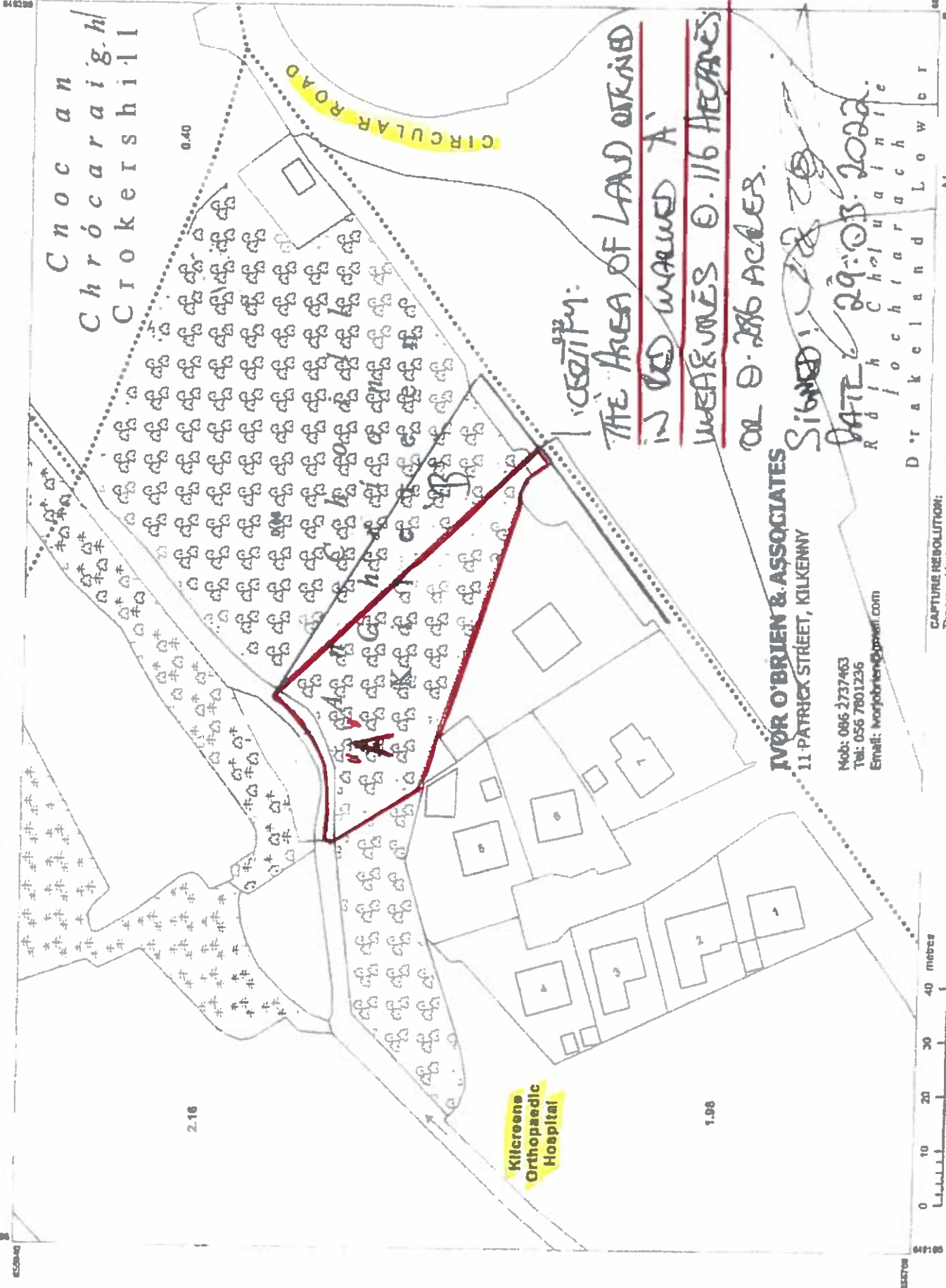

IVOR O'BRIEN & ASSOCIATES
11 PATRICK STREET, KILKENNY

Mob: 086 2737463
Tel: 056 7601236
Email: ivorbrien@gmail.com

CAPTURE RESOLUTION:
The map objects are only accurate to the
resolution at which they were captured.
Output scale is not indicative of data capture scale.
Further information is available at:
<http://www.osi.ie>; search 'Capture Resolution'

OUTPUT SCALE: 1:1,000

