



Comhairle Chontae Chill Chainnigh

Halla an Chontae Sraid Eoin Cill Chainnigh
R95 A39T

Pobail agus Áiteanna Inbhuanaithe a Chruthú

Kilkenny County Council

County Hall John Street Kilkenny
R95 A39T

Creating Sustainable Communities and Places



Date: 9th May, 2024

Our ref: D28/698/C

**TO: THE CATHAOIRLEACH AND EACH MEMBER OF KILKENNY
COUNTY COUNCIL**

**RE: DISPOSAL OF INTEREST IN LAND AT BALLYNOLAN & DEMENSE,
LEIGHLINBRIDGE, CO. CARLOW**

A Chara,

Notice is hereby given, that at a meeting of the Council to be held after the expiration of 10 days from the date of this notice, it is the intention of Kilkenny County Council, in accordance with Section 183 of the Local Government Act, 2001, to dispose of its interest in land at Ballynolan & Demense, Leighlinbridge, Co. Carlow – as identified on the attached map - to Shane Mullen, 112 Cedar Walk, Castle Oak, Co. Carlow. The Consent of the Minister for Housing, Local Government and Heritage is not required.

BACKGROUND

This land was acquired as part of the M9 Motorway Project. The total area measures 2678 m² (0.66 acres)

Lands comprises of a Laneway Plot 573z-1 and 573z-2 measuring 1802m² (0.44 acres) and Other Plots 573z-3 to 573z.7 inclusive measuring 876m² (0.22 acres).

A Section 183 was previously passed in 2019 to dispose of the Laneway, Plot 573z-1 and 573z-2 to Hugh McDonnell, Uncle of Shane Mullen. However, it did not complete and the adjoining land passed to his nephew Shane Mullen.

Plot 573z.3 is the frontage of Shane Mullen's farmyard and is within the boundary wall that he constructed.

The other Plots are all minor boundary amendments to rectify small areas that are registered to Kilkenny County Council within Mr Mullen's fields.

Transport Infrastructure Ireland have approved this transaction.

Each party are responsible for their own legal fees associated with this transfer.

Mise, le meas,

Martin Prendiville

Martin Prendiville
Head of Finance

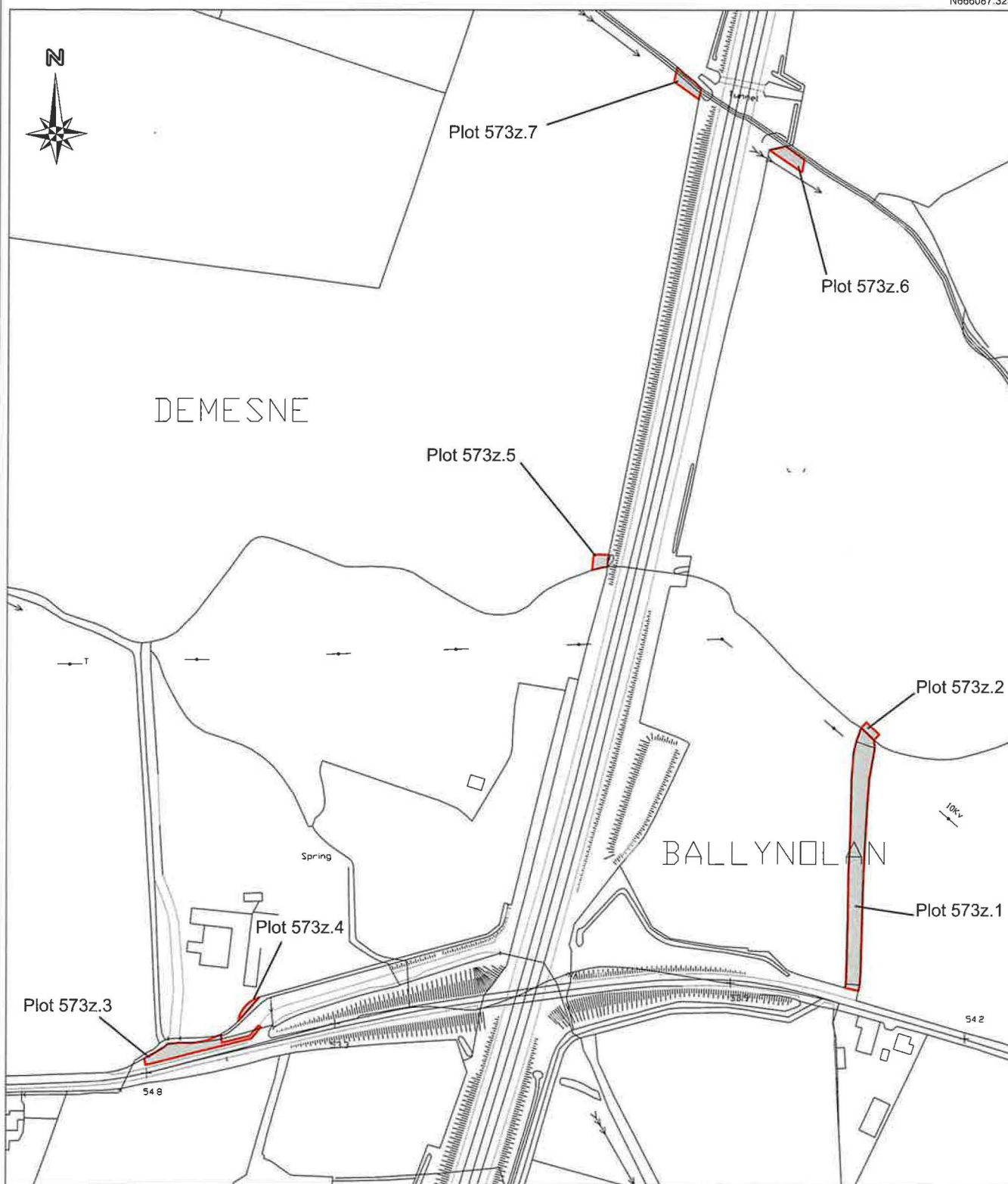
E667242.632
N665313.790

Plot	Area	Land	Townland	Folio	Owner
573z.1	0.1743 ha	Laneway	Ballynolan	CW28478F & CW29477F	Kilkenny County Council
573z.2	0.0059 ha	Laneway	Ballynolan	CW30650F	Kilkenny County Council
573z.3	0.0427 ha	Entrance & Wall	Ballynolan	CW30650F	Kilkenny County Council
573z.4	0.0043 ha	Agricultural	Ballynolan	CW30650F	Kilkenny County Council
573z.5	0.0087 ha	Agricultural	Demesne	CW30650F	Kilkenny County Council
573z.6	0.0162 ha	Agricultural	Demesne	CW30650F	Kilkenny County Council
573z.7	0.0157 ha	Agricultural	Demesne	CW30650F	Kilkenny County Council

0.2678 ha (0.66 acres)



Rev	By	Date	Description
C	ABM	2/24	Design change to Portrait. Plots 573z.3 to 5 added.
D	ABM	3/24	Plots 573z.3 extended to include wall.

Ordnance Survey Licence Number
2021/27/CCMA/KilkennyCounty Council

Project:		M9 Motorway		
Component:		Land at Moanduff		
Title:		Shane Mullen		
Designed By:		File Name:		Drawing No. M9-CPO/573-1D
Drawn By: ABM		Scale: 1:2500 (at A3)		
Checked By: ABM		Date: Dec 2018		

Location Plan

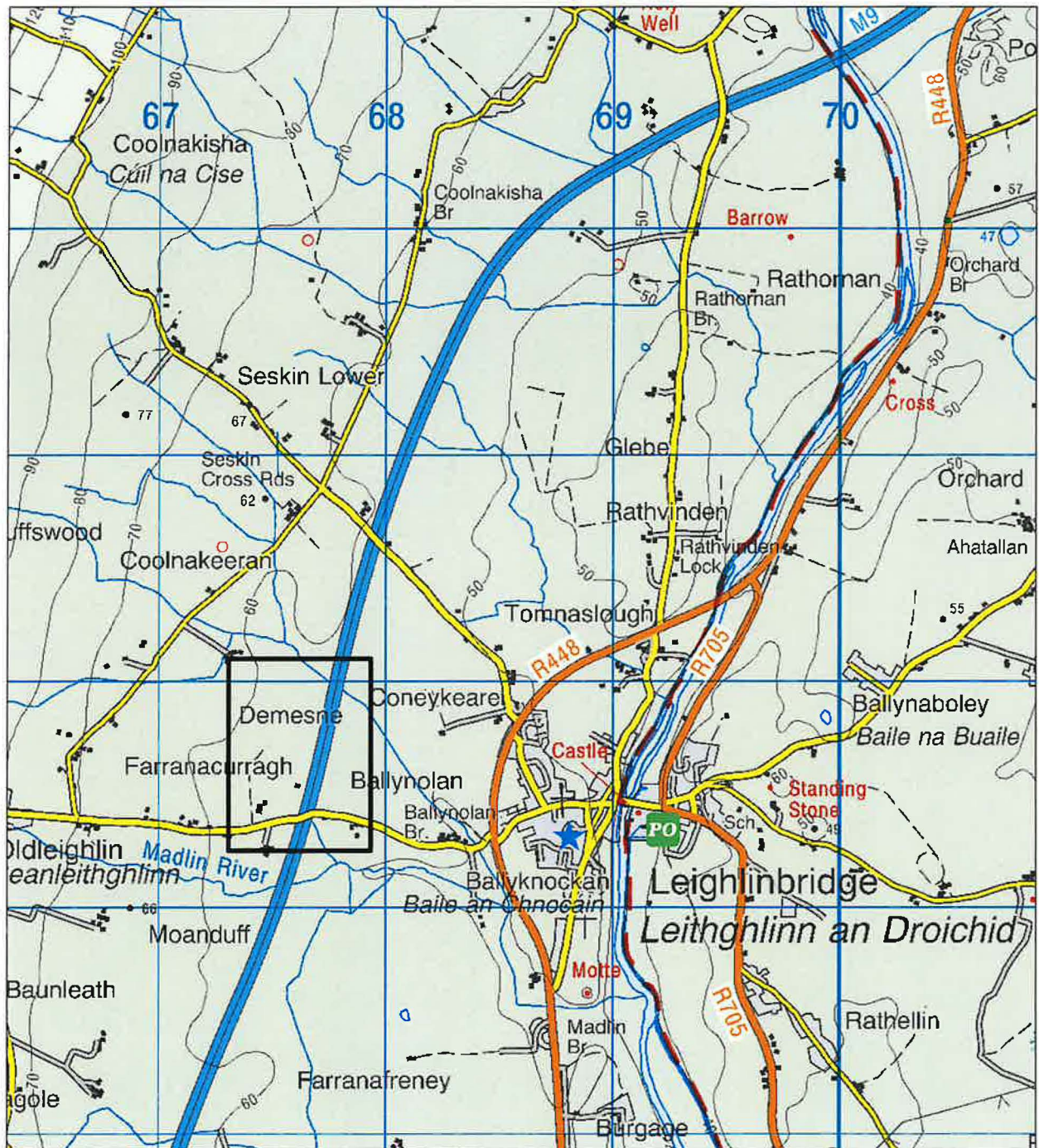

Land at Ballynolan & Demesne,
Leighlinbridge, Co Carlow