



Comhairle Chontae Chill Chainnigh

Halla an Chontae Sraid Eoin Cill Chainnigh
R95 A39T

Pobail agus Áiteanna Inbhuanaíthe a Chruthú

Kilkenny County Council

County Hall John Street Kilkenny
R95 A39T

Creating Sustainable Communities and Places



Date: 4th September, 2024
Ref: Land/Misc/140

**TO: THE CATHAOIRLEACH
AND EACH MEMBER OF KILKENNY COUNTY COUNCIL**

**RE: DISPOSAL OF INTEREST IN LAND AT PARKSGROVE, BALLYRAGGET, CO.
KILKENNY**

A Chara,

Notice is hereby given, that at a meeting of the Council to be held after the expiration of 10 days from the date of this notice, it is the intention of Kilkenny County Council, in accordance with Section 183 of the Local Government Act, 2001, to dispose of its interest in **Land at Parksgrove, Ballyragget, Co. Kilkenny**, as identified on the attached map, to Pascal Drennan, Parksgrove, Ballyragget, Co. Kilkenny.

Background

This land (Plot B on attached map) was acquired in 1980 as severed by N77 Road Realignment Scheme. It was agreed in 1980 to acquire Plot A from Michael Drennan (father of Pascal Drennan) and together with monetary compensation it was agreed that Plot B would be transferred to Michael Drennan as he owned the adjoining land to the north.

Pascal Drennan is now the registered owner of the adjoining land and it is proposed to complete this transaction. Mr Drennan has been occupying the land, Plot B since 1980. The area to be transferred measures 2030 m² (.203 ha). Kilkenny County Council will be responsible for all legal costs associated with the sale.

Mise, le meas,

Martin Prendiville

Martin Prendiville
Head of Finance

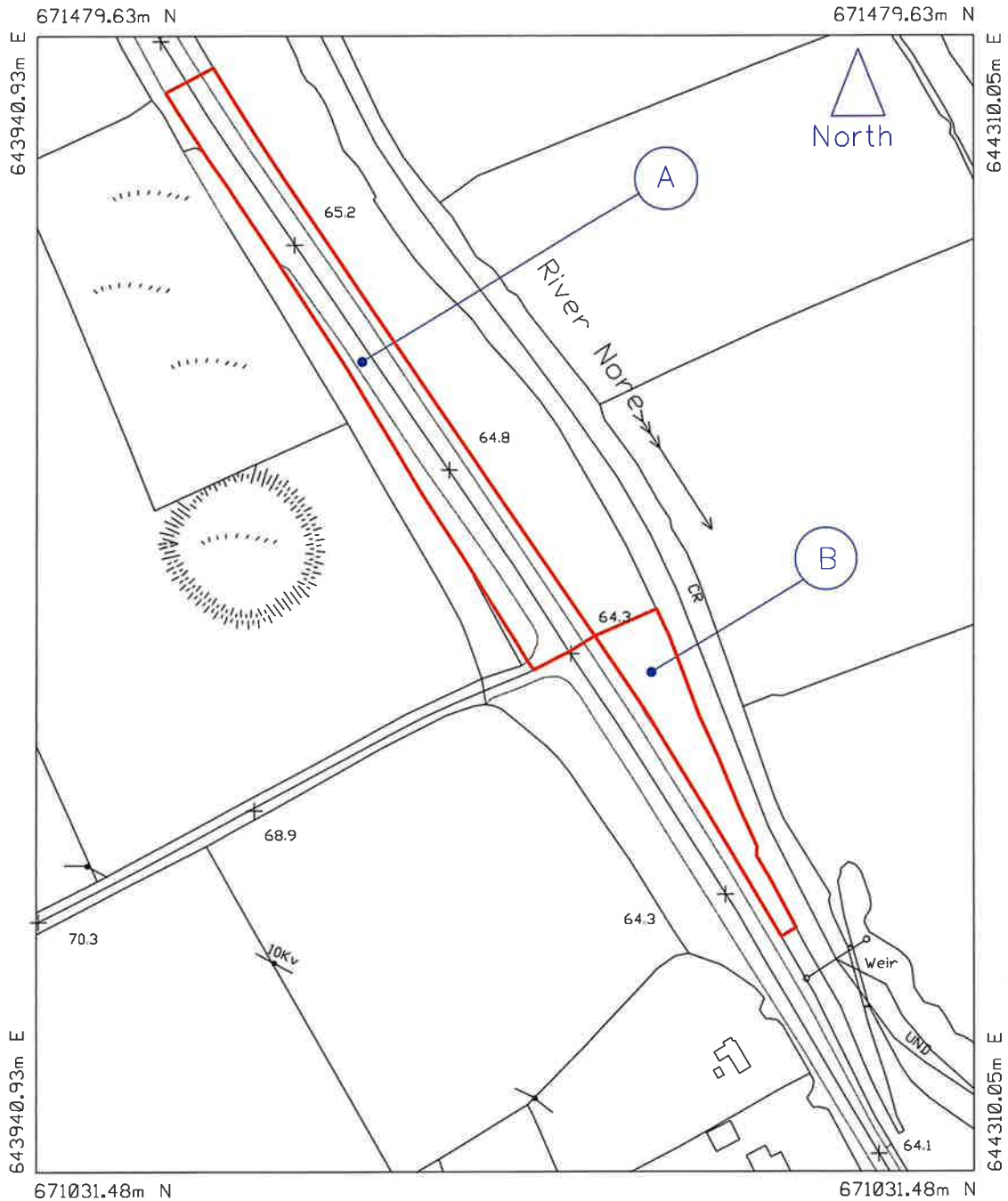

Lands to be transferred to Kilkenny County Council

Ref No:	Owner	Area	Description
A	Pascal Drennan, Parksgrove, Ballyragget, Co. Kilkenny.	0.624Ha	Public Road

Lands to be transferred to Pascal Drennan, Parksgrove, Ballyragget, Co. Kilkenny.

Ref No:	Owner	Area	Description
B	Kilkenny County Council, County Hall, John Street.	0.203Ha	Agricultural

Areas: As shown	Townland: Parksgrove	Date: 15/10/20	
Scale: 1/2500	O.S. Map Ref: 4466-A	Prepared by: pd	
Kilkenny County Council, County Hall, John St., Kilkenny. Tel: 056/7794000		Revision: Adjusted Areas 06/07/20 R1	
Comhairle Chontae Chill Chainnigh		Drawing No. LR/P Drennan/10 <small>© 2010 DRENNAN, ANDREWS & TYRELL</small>	

Based on Ordnance Survey map of Ireland, Licence No. Kilkenny County Council 2020/27/CCMA.

Location Plan

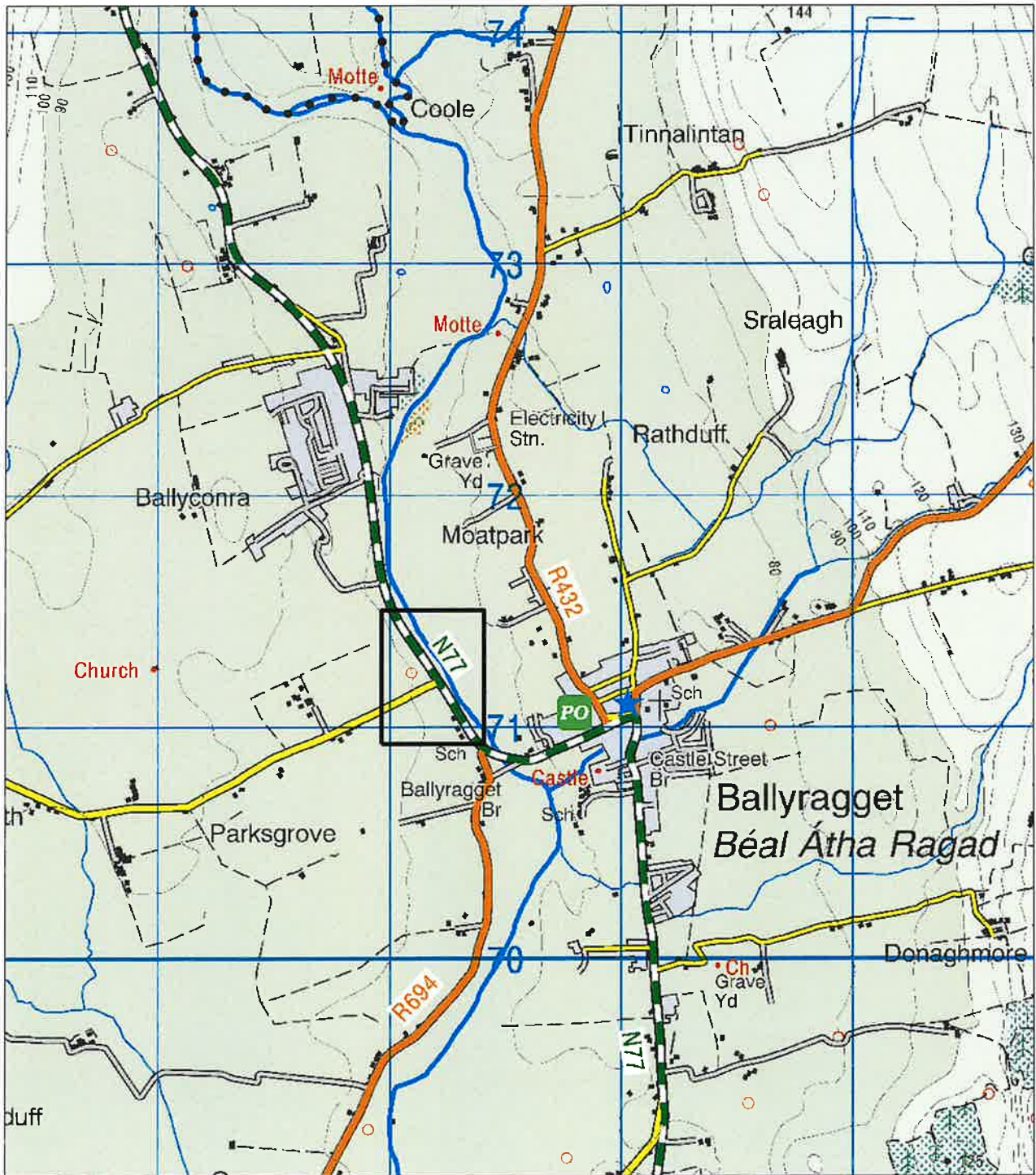

Land at Parksgrove, Ballyragget
Co Kilkenny